

BsT- Korbgrößen zur Sturzherstellung im DSs 37,5

Wärmedämmstein DSs37,5/12
mit Fertigteildecke ohne Anschlussbewehrung

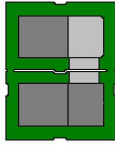

Sturz-
breite
12

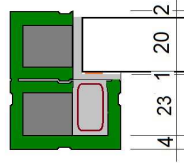

Bügel max. 7,5 x 17

Sturz-
breite
16

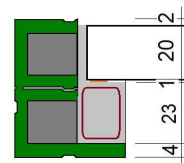

12 x 19

Wärmedämmstein DSs37,5/15

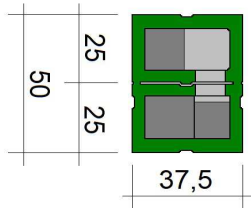

Sturz-
breite
15

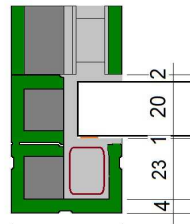

Bügel max. 11 x 17

Sturz-
breite
19

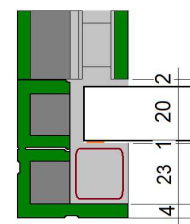

15 x 19

Wärmedämmstein DSs37,5/12
mit Ortbetondecke / Elementdecke

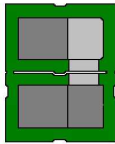

Sturz-
breite
12

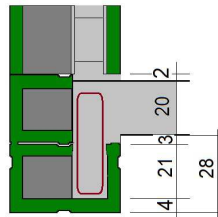

Bügel max. 7,5 x 38

Sturz-
breite
16

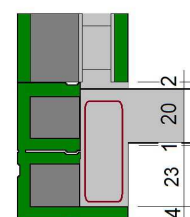

12 x 38

Wärmedämmstein DSs37,5/15

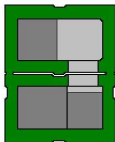

Sturz-
breite
15

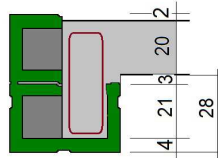

Bügel max. 11 x 38

Sturz-
breite
19

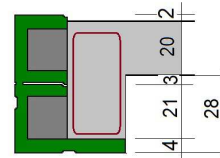

15 x 38

**Bearbeitung
mit Windows
Paint**

